

Güttler – Front press specialists

All action
at the front –
a vital
consideration



Avant SX 610-56 U



Duplex DX 30-45 with a tined unit



Duplex DX 30-45



Avant SX 30-45

This press that suits you best – robust and reliable!

AVANT & DUPLEX front press

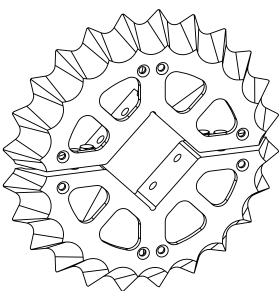

Designed by Gütler

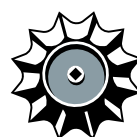

GÜTTLER[®]
Leading in Soil Structure



Avant SX 460-56 U with tined unit



A consistent approach with regard to agricultural solutions

We're not simply here to sell machines, but to provide agricultural solutions. Because this has been our policy for many decades, we are able to provide so much more than just one type of press – today, we are able to provide a complete modular system that enables us to offer front presses perfect for any farm and any soil. We thrive on finding solutions that meet your needs!

Ihr Hans Guttler

Güttler: the roller pioneer

“Re-compaction and soil structure” – this has been the Guttler motto for more than 35 years!

When Fritz Guttler developed and patented the prism rings® in 1976, the guiding principle was the primary idea of creating the ideal soil structure for a seedbed.

The sheep's hoof effect of the Guttler rollers has since become a well-known concept. Since then, the prism roller has been further developed and is nowadays probably the most effective tool to create an ideal seedbed: firm and fine underneath, loose and crumbly on top.

Designed by Guttler





Initially, our cultivators were attached to the front loader.



The Duplex was developed in 1985.



We have been supplying tined units for more than 20 years! Starting with only 2 rows.



The “golden hooves” at work

- Intensive crumbling of clods
- Highly-effective depth control and reconsolidation

Whichever design and diameter you require, a front unit will achieve the results you want from your soil and exceed your expectations.

Damp soil only sticks to the prism rings to a certain degree. The soil is never destroyed or turned into mud under any circumstances, but is broken up in accordance with its natural structure.

Never fear front units!



Saving while driving

Often, farmers worry unnecessarily about overloading the front axle on the tractor with a front unit. However, quite the opposite is true: the front unit ensures balanced axle load! A Gütler front press can offer a far more effective and more relaxed way of working in every aspect of field work. Use of a front press will provide a higher level of

driver comfort, reduce soil damage at the seed bed, and reduce fuel consumption as the tractor's wheels only create tracks to the depth of the tyre profile (every 1 cm of additional depth = 10% more energy), leading to balanced handling of the trailed or rear mounted units, and increased ground coverage thanks to more effective and faster operation.

A Gütler front press – a better balance all round!

Sample data:

Weight of the tractor (100 bhp, 4-cylinder engine) and power harrow:

Power harrow + seed drill = 2,000 kg
 Seeds = 500 kg
 Total = 2,500 kg
Front unit = 1,250 kg

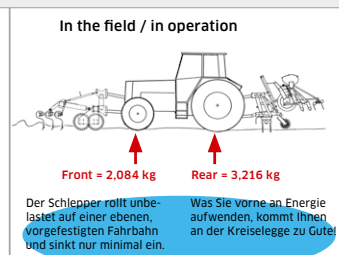
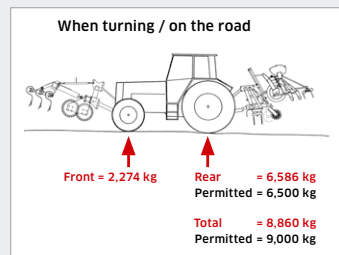
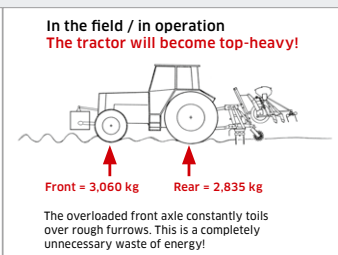
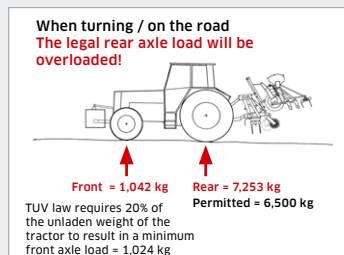

With a drill combination and front weight

When turning: increased rear axle loads = soil compaction

In operation: the tractor is top-heavy. The front axle tracks deeply and the power harrow must therefore work at the same depth.

With a drill combination and front unit

When turning: balanced weight distribution. The front axle is not overloaded in any way: compared with the unladen tractor, the front axle load only increases by approx. 200 kg.

In operation: the tractor travels easily and unladen on a pre-levelled and firm track.

Deep tracking caused by front weights



Energy is wasted and soil damaged in this way!

Wouldn't a front weight be cheaper?

Only at first glance! The tractor will become top-heavy and will track more deeply at the front.

Remember: **Every additional centimetre of track depth equates to:**

- 10% more fuel consumption (according to Prof. Volk of the FH Soest)
- The power harrow must move 150 tonnes (= 7 truckloads) more soil per hectare

When using a front unit, a larger tractor isn't required: the tractor will hardly sink itself at all and travels easily. The power harrow can be set considerably shallower! Soil that has already been crumbled at the front and re-compacted results in the power harrow using less energy. With excess engine performance and a quality front unit, the speed and therefore, the ground coverage is considerably increased!



The soil is already made firm and fine at the front of the tractor!



The tractor hardly creates tracks and rolls easily

A front unit from Güttler gives you more!

The tined units do not need to work very deeply. The tines only cut off the heads of the furrows.

They break up rough clods and level them, so that the following roller can effectively crumble and re-compact the soil.

Also useful on light soils



Avant SX 30-56

The correct front unit is extremely important...

not only to assist crumbling on heavy soils, but also on light soils for re-compaction.

Also in the spring on over wintered furrows:

The tines on the front unit are adjusted as level as possible, so that they level soil without bringing up damp soil. The tractor tracks only minimally and the following power harrow can run equally as shallow.

This will ensure no smearing within the profile of the seedbed!

Many farmers say: "I don't need a front press, I don't have any heavy soils!"

Incorrect: Guttler front units are the top performers on any soil!

The soil contact in front of the tractor promotes level and even seed placement!



With front weight:

Deep tracks. The power harrow must work deeper to level the soil. The seedbed is broken up unnecessarily deep, with the result being that not only does a waste of energy occur, but the seed can be dispersed too deeply and unevenly.

The Avant SX 30-56 front unit:

Optimal re-consolidation actually takes place in front of the tractor and the unladen tractor travels easily along a level and firm track. Minimal track depth means that the power harrow can work on a level surface. Compare the track of the front axle with the depth of the footprints at the bottom of the access ladder! Result: a perfect seedbed that can be walked over with shoes - easily achieving the ideal depth!

Success in adverse conditions!



Avant SX 30-45

Save work, time and money!

The damper the soils (tilling in late spring), the more important it is that it is cultivated in a single working pass. A second pass is unnecessary!

The front unit plays a decisive role here. Working with a front unit protects the equipment, as it results in reduced wear on the trailed or mounted

units and the tractor. The tractor itself travels on an even, firm track and does not bump from furrow to furrow, as the soil in front of the tractor has already been crumbled, levelled and re-consolidated.

That way, you are protecting both the driver and the tractor.

A calming feeling

If the weather in autumn is unpredictable, you can ensure that cultivations can be carried out in one

pass on ploughed ground, meaning that the work will be completed in shorter weather windows.



The soil is already levelled, crumbled and re-consolidated in front of the tractor.

... the tractor travels easily on the level ground and hardly creates deeper wheelings. The power harrow can therefore work at a more even depth.

Result: A better seedbed with less energy.

- More fine soil in the sowing zone
- Improved crop emergence
- Healthier crops
- Less winter kill

Also able to cope with crop residues



Duplex DX 30-56 with a tined unit

Using a tined unit to incorporate crop residues

The 3 rows of tines with under frame clearance of 460 mm allows straw and crop residues better flow. If large amounts of straw are incorporated within the ground and immediately processed by the tined unit, it can lead to blockages. In such cases, tines are not required because the soil has been freshly worked and usually has been levelled by the

cultivator. In this instance, the tines are simply lifted horizontally or the tined unit is simply removed. When the cultivated field has had several days to settle, the tines experience sufficient resistance in firm soil so that they vibrate and shake the straw that has rotted and decomposed.

The straight, vertical tines hardly pick up any straw or stones



Duplex DX 30-45 with a tined unit



Duplex DX 41-45 with a tined unit

No steering yoke required



Duplex DX 30-45 with front-mounted tined unit



Press rings with narrow edges run dead straight like the wheels of a train on the track. Steering headstocks are therefore essential.

Gütler rings do not behave in a “track-like” way, and therefore do not require a steering headstock.

Without a steering yoke, we benefit from the following positive points: what isn't there cannot break or wear, plus no more yawing movements from side to side – the Gütler press gives gentle motion even at high speeds – essential for GPS steering systems.

More than the perfect front unit – unbeatable versatility

Modular unit construction: manufacturing the modular system is somewhat more expensive,

but it provides substantially greater flexibility for the customer.



A duplex roller without a tined unit with 3 hitch points transformed into a roller or trailed unit on the power harrow for a perfect seedbed for root crops, oilseed rape or vegetables!



The majority of Gütler front units can be converted into rear-mounted cultivators by means of a rear headstock.



An SX 610-56 U fitted with a draw bar and depth wheels converts to form a trailed press.

Every aspect demonstrates the benefits of using Gütler front presses in soil cultivation.



Detailed and smart designs!



Tined units

- A stable lead frame made from 80 x 50 mm hollow profile
- 3 rows to provide greater clearance and increased stability
- Robust side plates as standard

Strong tines with 45 x 12 mm width

- Robust and long-lasting
- Larger 460 mm clearance under the frame
- Straight mounted front tine, brings less straw and fewer stones to the surface

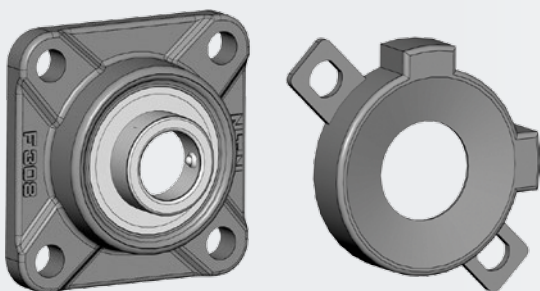

Protective caps for the bearings

- Double-sealed ball bearings are used
- The bearings in the front units are sometimes exposed to extreme fouling.
- As a result, all bearings are fitted with an additional protective cap

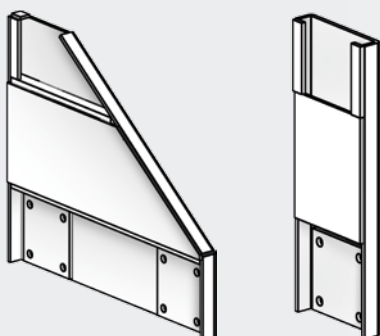

End plates

- The end plates on the roller frame are reinforced and double-sided
- This results in extremely torsion-resistant and stable components

The little things that matter



Our headstocks offer several hitch points

...form the power that underpins the established Güttnler standard

The headstocks

Our headstocks offer several hitch points. This is essential because the measurements of the front hydraulics differ considerably from tractor to tractor.

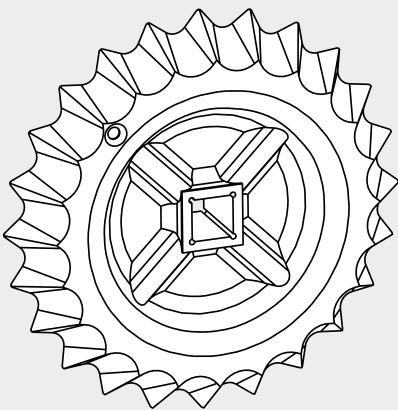

45 cm rings

The 45 cm rings are axially loaded on the sprung steel shafts so that they remain free from play for a long time. In the event of a repair, pre-tensioning is carried out on site, and no specialist equipment is required.

56 cm rings

The split rings made from malleable cast iron (ductile) are securely bolts to the 140 x 140 axle by 4 bolts (M16). On the extremely rare occasion that one ring actually breaks, it can be quickly exchanged without taking the roller apart.

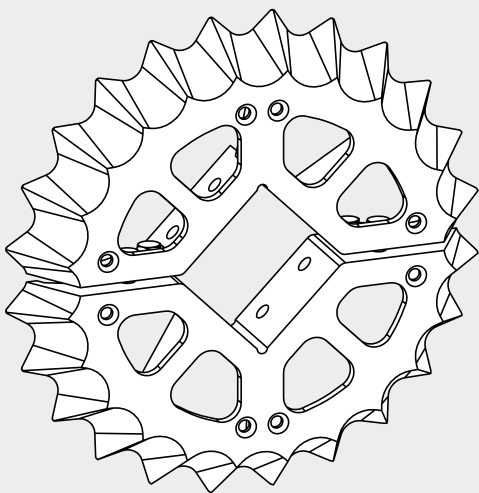

Designed by Güttnler

And there you have it:

A Güttnler front press will hold its value and is a sought after item on the used-equipment market!

Avant 45



Working widths from 2.5 to 4 m For medium to heavy soils capable of crumbling

- Front unit with Simplex prism roller® in 45 cm Ø cast iron
 - 140 x 80 stable roller frame
 - Sprung steel roller axles, square
 - With centre bearing consisting of four sub-bearings (each roller in the power harrow must be capable of withstanding up to 2,500 kg)
 - Reinforced, dustproof ball bearings with additional dust caps
- Standard equipment:**
- Cat. 2 headstock for front attachment
 - Culti-tined unit - 15 cm tine spacing, 3 rows
 - Side plates for tined unit

Type	Working width	Transport width	Roller	Weight
Avant 26-45	2.50 m	2.60 m	SX 26-45	945 kg
Avant 30-45	2.92 m	3.00 m	SX 30-45	1,015 kg
Avant 35-45*	3.42 m	3.50 m	SX 35-45	1,135 kg
Avant 41-45*	4.00 m	4.10 m	SX 41-45	1,255 kg

Accessories	Weight
Headstock for rear attachment	153 kg
Warning boards with lighting	



The Avant is based on the Simplex prism roller®: something that has been tried and tested over 10,000 times on a power harrow, will not let you down as a front unit.

Clay soil: Potatoes can be placed directly into the even winter furrows using the Avant. Compared to PTO units, the soil is not formed into lumps, resulting in fewer clods when planting!

With the rear headstock being used for seedbed preparation (can be retrofitted at any time)

Avant 56



For large tractors and high speed – from light sandy soils to heavy, yet still crumbly, soils

- Front unit with Simplex prism roller® made from shock-proof ductile iron, 56 cm Ø
 - 140 x 140 stable roller frame
 - 140 x 140 roller axle
 - Without centre bearing, consisting of 2 sub-bearings (except the Avant 45-56 = with centre bearing)
 - Strengthened, dustproof ball bearings with additional protective cap
- Standard equipment:**
- Cat 2. headstock for front attachment
 - Stable tined unit, 3 rows, 15 cm tine spacing
 - Robust side plates on tined unit

Type	Working width	Transport width	Roller	Weight
Avant 26-56	2.50 m	2.60 m	SX 26-56	1,040 kg
Avant 30-56	2.92 m	3.00 m	SX 30-56	1,210 kg
Avant 35-56*	3.26 m	3.50 m	SX 33-56	1,365 kg
Avant 41-56*	4.00 m	4.10 m	SX 41-56	1,590 kg

Accessories	Weight
Headstock for rear attachment	153 kg
Warning boards with lighting	



For large tractors and high speed!

For light sandy soil to heavy, yet still crumbly, soils

The SX 56 in lightweight Synthetic Ultra for power harrows has the same construction and must be capable of withstanding loads of up to 3,500 kg!

* Transport widths over 3 metres requires dispensation in order to travel on public roads.

Avant 56 hydraulic folding



4 to 6 metre working widths

- Front unit with Simplex prism roller® made from ductile iron, 56 cm Ø

Standard equipment:

- Cat. 2 headstock for front attachment
- U-stand

Hydraulic folding Simplex prism roller (U-folding, 3 sections)

Type	Working width	Transport width	Notes	Weight
Avant 420-56 U	4.10 m	2.70 m	1.80 m + 2 x 1.10 m U-folding	1,400 kg
Avant 460-56 U	4.54 m	2.70 m	1.80 m + 2 x 1.37 m U-folding	1,500 kg
Avant 510-56 U	5.07 m	2.70 m	1.80 m + 2 x 1.63 m U-folding	1,750 kg
Avant 610-56 U	6.15 m	2.70 m	1.80 m + 2 x 2.17 m U-folding	2,050 kg

Culti-tined unit 150 mm tine spacing, 3 rows complete with side plates

Description	Working width	Transport width	Comments	Tines	Weight
For Avant 420-56 U	2 x 2.00 m	2.70 m	Hydraulic folding	26	590 kg
For Avant 460-56 U	2 x 2.25 m	2.70 m	Hydraulic folding	30	640kg
For Avant 510-56 U	2 x 2.50 m	2.70 m	Hydraulic folding	32	700 kg
For Avant 610-56 U	2 x 3.00 m	2.70 m	Hydraulic folding	36	800 kg

Single row levelling harrow

Description	Working width	Transport width	Comments	Weight
For Avant 420-56 U	2 x 2.00 m	2.70 m	Hydraulic folding	390 kg
For Avant 460-56 U	2 x 2.25 m	2.70 m	Hydraulic folding	400kg
For Avant 510-56 U	2 x 2.50 m	2.70 m	Hydraulic folding	410 kg
For Avant 610-56 U	2 x 3.00 m	2.70 m	Hydraulic folding	430 kg

Accessories

Double spring incl. holder, screws and nut

The double springs are supplied separately and must be installed on site.

Chassis with draw bar for connecting

Customer feedback:

Gerhard Finke Agricultural Contractor

Maasen, Lower Saxony
between Bremen and Hanover

Soil: Predominantly light sandy soils

Combination of machines: JD 6430 (125 bhp),
Avant 56 with tined unit in the front,
6-row maize seeder in the rear

Annual performance: Approx. 200 ha maize seed

Mr Finke previously used the Güttnler roller because of the Simplex roller in his power harrow and has already had a positive experience.

"Thanks to the Avant front press from Güttnler, we can carry out additional soil preparation while sowing maize. And that takes place without requiring any additional horsepower from the tractor, as thanks to the re-consolidation by the rollers, the tractor travels easily over the soil.

Optimal re-consolidation on light sandy soil.
Pictured here, with the agricultural contractor
Gerhard Finke (left) from Maasen



In lowland areas and on our light soils, 125 bhp is all that we need to run the 6-row maize seeder together with the 4.5 m wide Güttnler Avant at the front," enthused Finke. An additional benefit is the fact that instead of having a dead weight up front, the front press plays an active part in soil cultivation.



Avant SX 610-56 U with tined unit
for sowing maize



Avant SX 610-56 U with levelling
harrow for sowing maize



Avant SX 610-56 U with levelling harrow
for sowing root crops and oilseed rape



Avant SX 60-56 U with levelling
harrow for seedbed preparation



Avant SX 610-56 U without levelling
harrow for tined sowing machine



Avant SX 610-56 U with tined unit,
draw bar and depth wheels (retrofitted)



Front-mounted tined unit, 3 row



2.70 m transport width



Levelling harrow

Duplex 45



1.5 – 4 metre working widths: the “crocodile bite” on the Duplex is able to process quite heavy, sticky soils that do not crumble very well

- Extremely robust Cat. 2 headstock (130 kg unladen weight)
- 140 x 80 stable roller frame
- Sprung steel roller axles, square
- With a centre bearing consisting of 8 sub-bearings (also for pushing front-end hydraulics)
- Dustproof ball bearings with additional protective cap

A	Type	Working width	Transport width	Material	Weight
	DX 16-45	1.57 m	1.70 m	Ductile iron	490 kg
	DX 27-45	2.57 m	2.70 m	Ductile iron	740 kg
	DX 30-45	2.92 m	3.00 m	Ductile iron	785 kg
	DX 34-45*	3.35 m	3.42 m	Ductile iron	870 kg
	DX 41-45*	4.10 m	4.20 m	Ductile iron	1,020 kg

B	Multi-tined unit 150 mm tine distance, 3 rows complete with side plates					
	Working width	Transport width	Comments	Number of tines	Weight	
	For DX 27	2.50 m	2.50 m	Rigid	16	340 kg
	For DX 30	3.00 m	3.00 m	Rigid	18	380 kg
	For DX 34*	3.50 m	3.50 m	Rigid	22	420 kg
	For DX 41*	4.00 m	4.00 m	Rigid	26	460 kg

C	Accessories	Weight
	Headstock DPT-45 for rear attachment, for Duplex with tined unit	153 kg
	Warning boards with lights	
	Double spring incl. holder, screws and nut	The double springs are supplied separately and must be installed on site.
	Adapter brackets for Accord front tank DF 1 + DF 2	



Foldable Duplex 45

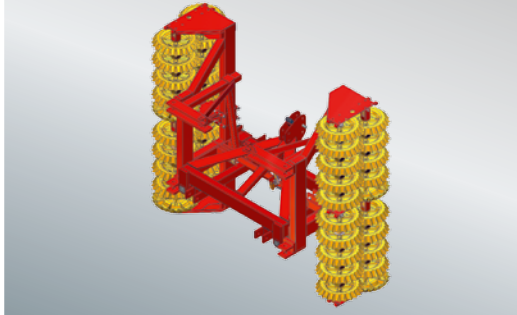
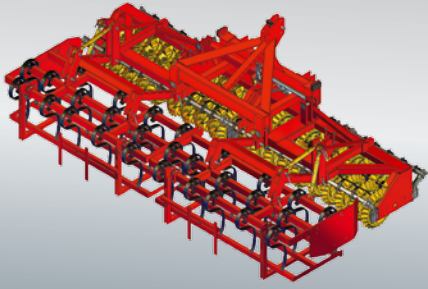

DX 610 U with draw bar and depth wheels (retrofitted)



DX 420 V for seedbed preparation for root crops, oilseed rape and vegetables



DX 420 U with DF 1 front tank



With rear headstock for seedbed preparation

4 to 6 metre working widths For medium to extremely heavy soils

- Front unit with Duplex prism roller® ductile iron, 45 cm Ø
- Option for front or rear attachment
- With Cat. 2 headstock
- Utilised all-year round, even on wet, binding soil
- Also ideal in spring on root crops, corn, vegetables etc.

A Hydraulic folding unit V-folding - 2 parts or: overhead folding = 3 m middle section + 2 side sections

	Working width	Transport width	Material		Weight
DX 420-45 V	4.10 m	2.52 m	2 x 2.05 m	V-folding	1,400 kg
DX 420-45 U	4.10 m	3.00 m	3 m + 2 x 0.55 m	O-folding	1,440 kg
DX 460-45 V	4.60 m	2.52 m	2 x 2.30 m	V-folding	1,500 kg
DX 460-45 U	4.60 m	3.00 m	3 m + 2 x 0.80 m	O-folding	1,530 kg
DX 510-45 V	5.00 m	2.52 m	2 x 2.50 m	V-folding	1,600 kg
DX 610-45 V	6.00 m	2.52 m	2 x 3.00 m	V-folding	1,770 kg
DX 610-45 U	6.00 m	3.00 m	3 m + 2 x 1.50 m	O-folding	1,800 kg

B Culti-tined unit 150 mm tine spacing, 3 rows, complete with side plates

	Working width	Transport width	Comments	Number of tines	Weight
For DX 420 V	2 x 2.00 m	2.52 m	Hydraulic folding	26	690 kg
For DX 420-45 U	3 m + 2 x 0.50 m	3.00 m	Manual folding	24	
For DX 460-V	2 x 2.25 m	2.52 m	Hydraulic folding	30	740 kg
For DX 460-45 U	3 m + 2 x 0.75 m	3.00 m	Hydraulic folding	28	

2 x 0.50 manual folding extension to a 3 m tined unit

C Accessories

	Weight
DPT-45 headstock for rear mount, for Duplex tined unit	153 kg
Double spring incl. holder, screws and nut	The double springs are supplied separately and must be installed on site.
Draw bar and depth wheels to convert to trailed unit	

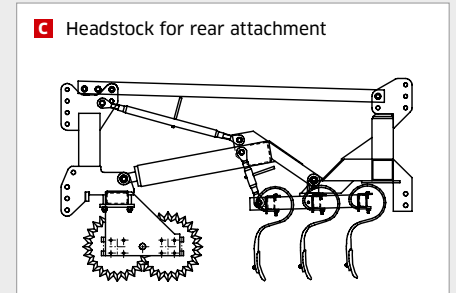
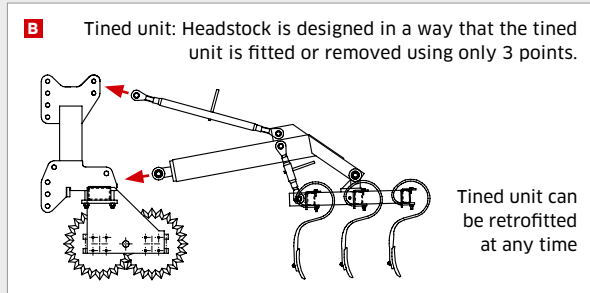
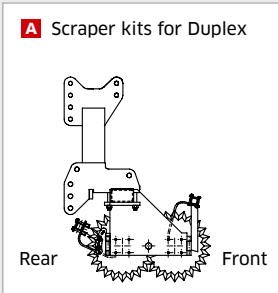

Duplex 56



1.5 - 4 metre working widths: for large tractors and high speeds The “crocodile bite” is able to cultivate heavy, sticky soils that do not crumble very well

- Extremely robust Cat. 2 headstock (unladen weight 130 kg)
- 140 x 140 stable roller frame
- 140 x 140 roller axle
- Without centre bearing, consists of 2 sub-bearings (except DX 411-56 = with centre bearing)
- Dustproof ball bearing with additional protective cap

A Type	Working width	Transport width	Material	Weight
DX 15-56	1.50 m	1.64 m		550 kg
DX 26-56	2.50 m	2.64 m		830 kg
DX 30-56	2.86 m	3.00 m		950 kg
DX 34-56	3.30 m	3.42 m		1,100 kg
DX 41-56	4.04 m	4.20 m		1,250 kg

B Multi-tined unit 150 mm tine spacing, 3 rows, complete with side plates					
	Working width	Transport width	Comments	Number of tines	Weight
For DX 26	2.50 m	2.50 m	Rigid	16	340 kg
For DX 30	3.00 m	3.00 m	Rigid	18	380 kg
For DX 34*	3.50 m	3.50 m	Rigid	22	420 kg
For DX 41*	4.00 m	4.00 m	Rigid	26	460 kg

C Accessories			Weight
DPT-56 headstock for rear mount, for Duplex with tined unit			153 kg
Warning boards with light			
Double spring incl. holder, screws and nut	The double springs are supplied separately and must be installed on site.		
Adapter brackets for Accord front tank DF 1 + DF 2			



DX 30-56 with tined unit



DX 30-56 with tined unit and rear headstock for seedbed preparation



DX 30-56 as a roller for the front and rear

Foldable Duplex 56

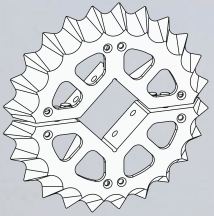

Designed by Güttler



4 to 6 metre working widths For light to extremely heavy soils

- Frontgerät mit Duplex Prismenwalze®
- Front unit with Duplex, ductile iron 56 cm Ø prism roller
- With Cat. 2 headstock
- Can be used all year-round, even on wet, binding soils
- Also ideal in spring on root crops, grain, vegetables

A Hydraulic, V-folding units = 2 sections, or overhead folding = 3 m middle section + 2 side sections

	Working width	Transport width	Comments	Weight
DX 420-56 V	4.10 m	2.75 m	V-folding	1,750 kg
DX 460-56 V	4.60 m	2.75 m	V-folding	1,870 kg
DX 510-56 V	5.05 m	2.75 m	V-folding	2,100 kg
DX 610-56 V	6.05 m	2.75 m	V-folding	2,500 kg

B Multi-tined unit 150 mm tine spacing, 3 rows, complete with side plates

	Working width	Transport width	Comments	Number of tines	Weight
Adapter for tined unit for DX 56 Ø			Must always be ordered at the same time!		200 kg
For DX 420-56 V	2 x 2.00 m	2.75 m	Hydraulic folding	26	200 kg
For DX 460-56 V	2 x 2.25 m	2.75 m	Hydraulic folding	30	690 kg
For DX 510-56 V	2 x 2.50 m	2.75 m	Hydraulic folding	32	830 kg
For DX 610-56 V	2 x 3.00 m	2.75 m	Hydraulic folding	36	1,000 kg

C Accessories

- Double spring for the tines
- Chassis with draw bar to connect
- Scrapers on front or rear

DX 610-56 V with chassis and draw bar (retrofitted) >



A Scraper kits for Duplex

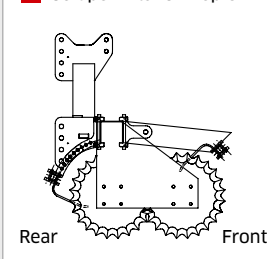

B Tined unit: Headstock is designed in a way that the tined unit is fitted or removed using only 3 points

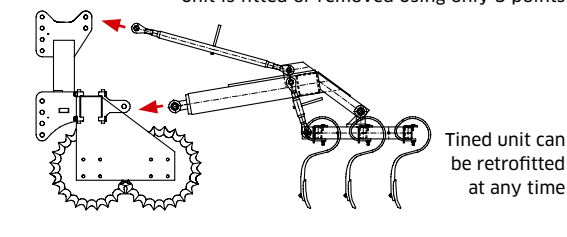

C Headstock for rear attachment

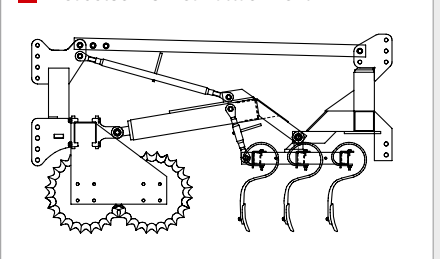

Your soil deserves the best!



The Güttler roller with the golden hoof.

Designed by Güttler

Re-compaction and soil structure – our guiding principles

Güttler is the pioneer of re-compaction. When Fritz Güttler developed and patented the prism rings® in 1976, the guiding principle was the primary idea of creating the ideal soil structure for a seedbed. The *sheep's hoof effect* of the Güttler rollers has since become a well-known concept.

We are not just mechanical engineers: you and your crop farming requirements are our primary concern. It is precisely because we understand the needs of crop farming that we are able to manufacture the necessary technical solutions. So why not take advantage of our many decades of experience?

The name Güttler stands for quality that you can count on in machine and crop production!



Mayor, Master and Magnum trailed rollers

For the perfect seedbed: protects against capping and erosion, protects the soil, unbeatable self-cleaning! Excellent on pastureland.



Simplex prism roller®

The solution when it comes to power harrowing: made from synthetic materials, the Simplex is up to 50% lighter, which is what makes it unique. Non-contact scrapers and easy to pull!



Mediana

This medium-weight seed roller from Güttler protects both the tractor and the soil. Perfect for root crops, vegetables grain and rapeseed, for front and rear!



GreenMaster, the 5-in-1 system for pastureland and cultivation: the first effective device to combat common panicles. Modular construction system: a harrow and roller can be used separately or combined.



Matador, the multi-functional device for front and rear, for fields and pastureland, incorporating a strong front sowing roller, a pastureland roller at the rear. Used to combat the European corn borer.



SuperMaxx®

Double the ground coverage and half the fuel consumption. The year-round device for level stubble processing, weed control, mixing in slurry and seedbed preparation.

Images and technical data are provided for information only and are non-binding. Güttler reserves the right to make changes without notice.

Healthy crops – reliable yields!



GÜTTLER®

Leading in Soil Structure

